



THE GREENPOP FOUNDATION

# HGZ DESIGN PRESENTATION

FAITH & HOPE FOUNDATION  
GA-RANKUWA



# SITE LOCATION

## CONTEXT

The Faith & Hope Foundation site is situated in ERF 1381 UNIT 23 towards the South of Ga-Rankuwa Pretoria. It is Currently owned by the Municipality but Faith & Hope foundation have been granted a ten year lease for the site.

The site is currently used for initial small scale agricultural use and hosting community classes but FHF want to expand its operations to include the full extent of the site.

## LEGEND

HGZ Site Boundary



# SITE DIVISION / ACCESS

## CONTEXT

The overall site area for ERF 1381 is approximately **4175m<sup>2</sup>**. The average site area delivered under the HGZ projects scope of works is between **700-900m<sup>2</sup>**. This means works will need to be prioritised selectively in terms of importance and what aligns with the project budget.





The site is unfenced and security is an issue so a strategy around security and having a continued presence on site must be considered.

Site access is from a point on the sites northern boundary and links directly with the main building on site which is currently used for hosting classes run by F&H foundation.

There are some other small structures on site including a small shack structure and ablutions block which will require renovation.

There is currently a small area used for agriculture on site which can be expanded on further.

## LEGEND

- HGZ Site Boundary 
- Extended Site Boundary 
- Northern Site Access 
- Community Vehicular Access 



**DESIGN ITERATION 01**



**DESIGN ITERATION 02**



# CONCEPT MASTERPLAN

## DESIGN ELEMENTS

The concept masterplan design was developed in collaboration with FHF over the course of two meetings and contains the following elements.

- 1. Community Centre / Hall
- 2. Container / Outdoor Classroom
- 3. Shaded Amphitheatre / Events Space
- 4. Recreational Lawn Area
- 5. Recycling Area
- 6. Nursery
- 7. Kraal
- 8. Composting Zone
- 9. Market Garden Zone
- 10. Herb Garden
- 11. Silvopasture Zone
- 12. Parking Areas
- 13. Security Guard Shack
- 14. Ablutions

## LEGEND

HGZ Site Boundary 







# CONCEPT-ACCESS & CIRCULATION

## SITE DIVISION

The access and circulation strategy builds off the current central entrance and axis which links the northern site access with the main community centre. A second central axis running from South West to South East divides the site into two functional zones, the North being agriculture and processing and the South being propagation, recycling and biomass processing.

A pedestrian axis links the agricultural zone with the main events and processing area at north east. Parking zones are associated with the Northern events space near the Northern entrance and to the South East corner relating to the Community Centre.

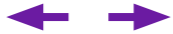
## LEGEND

- HGZ Site Boundary 
- Northern Site Access 
- Main Vehicular Access 
- Perimeter / Security Access 
- Pedestrian Access 
- Parking 

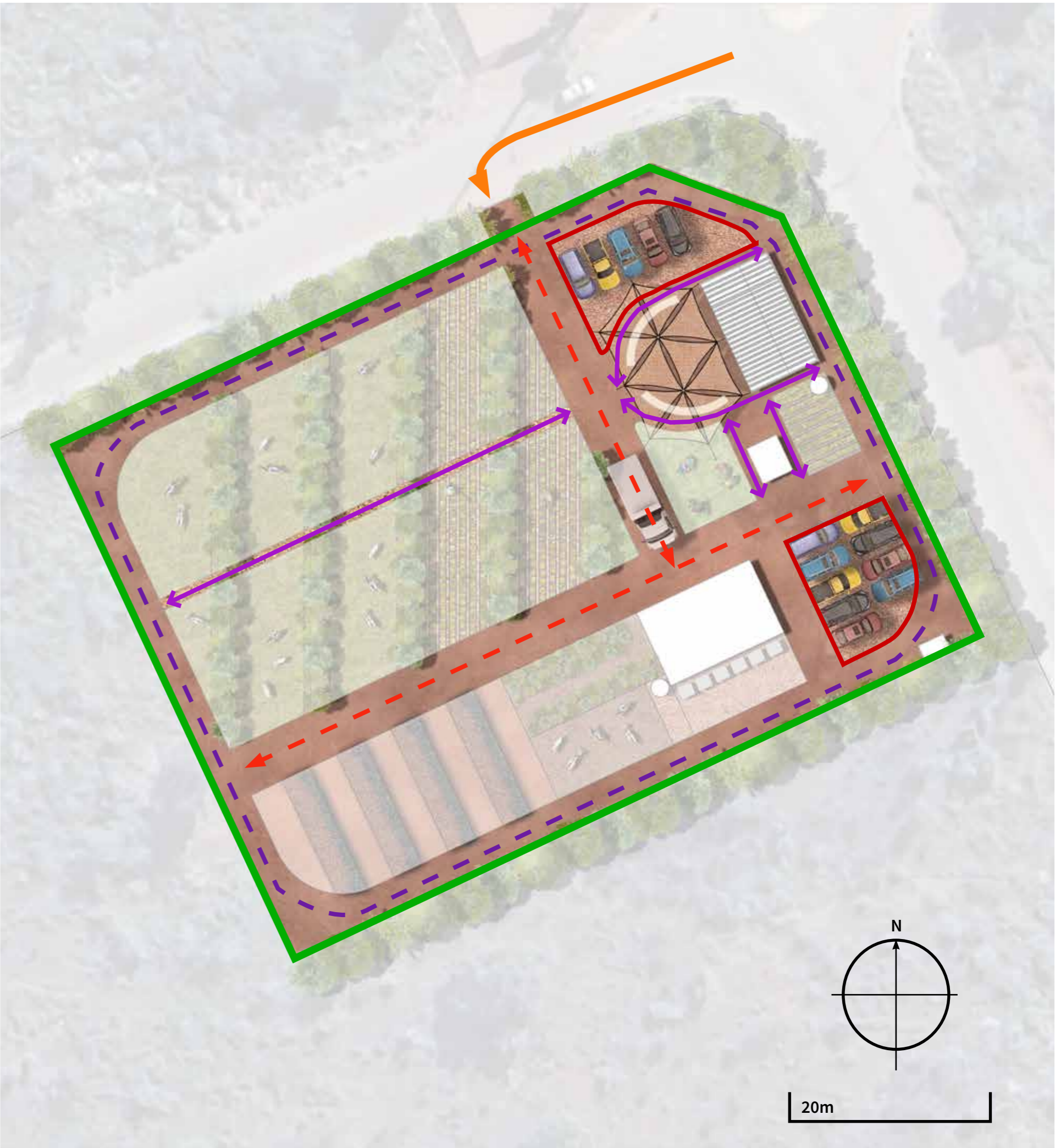

# CONCEPT-SHADE & AMPHITHEATRE

## PRECEDENT IMAGERY

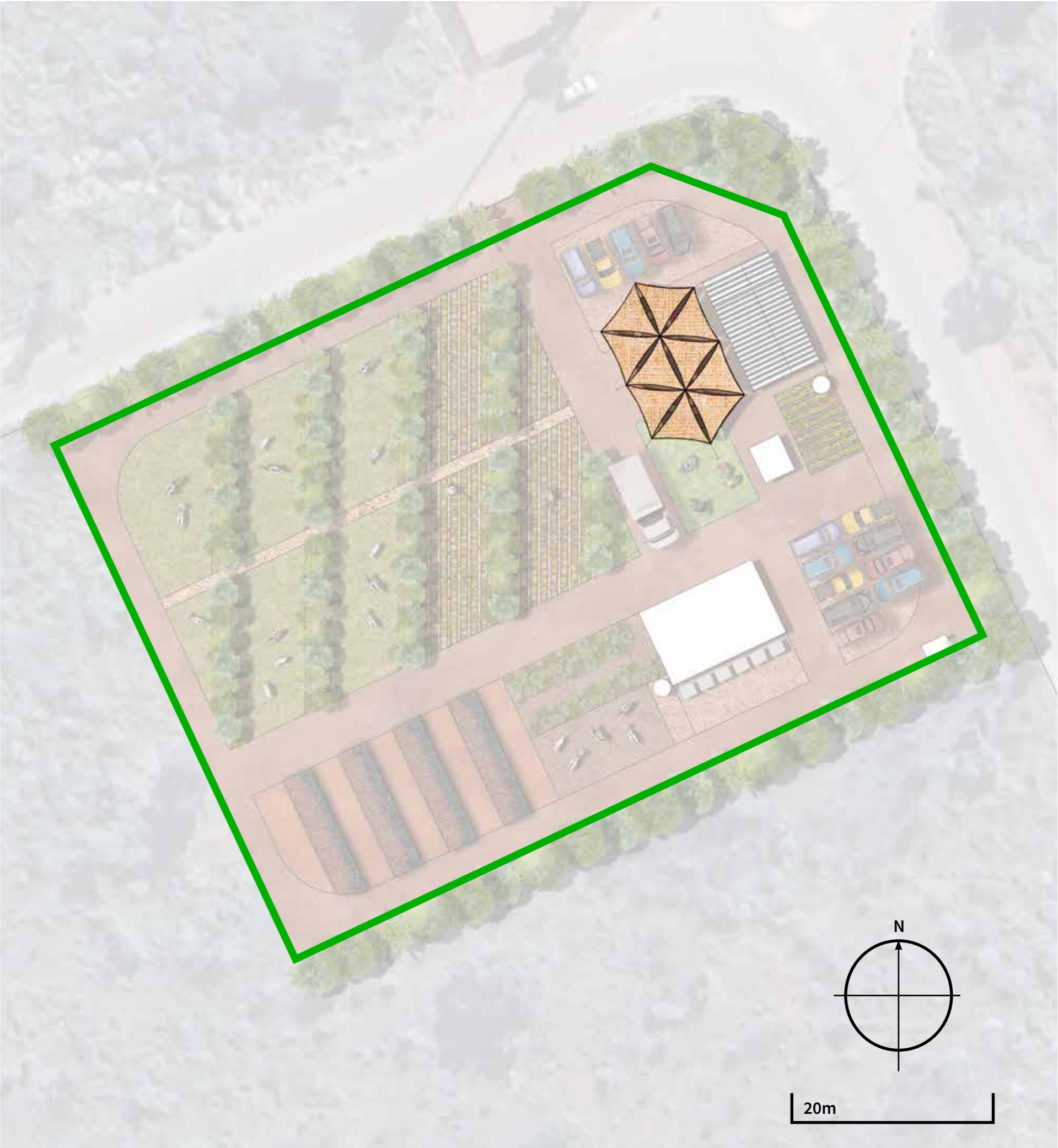

# CONCEPT-CLASSROOM AREA

## PRECEDENT IMAGERY

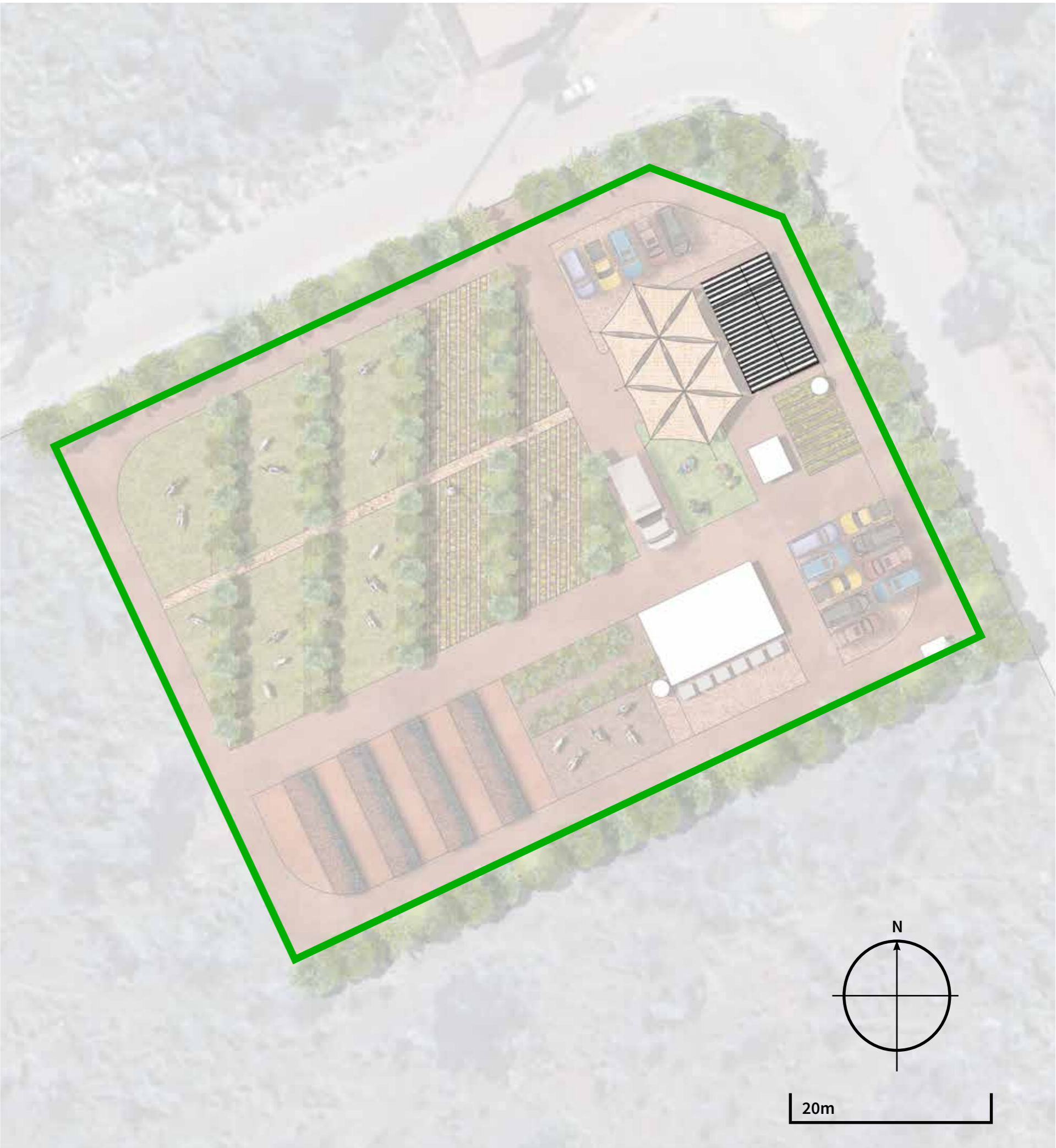

# CONCEPT-RECREATIONAL LAWN

## PRECEDENT IMAGERY



# CONCEPT-NURSERY, KRAAL

## PRECEDENT IMAGERY

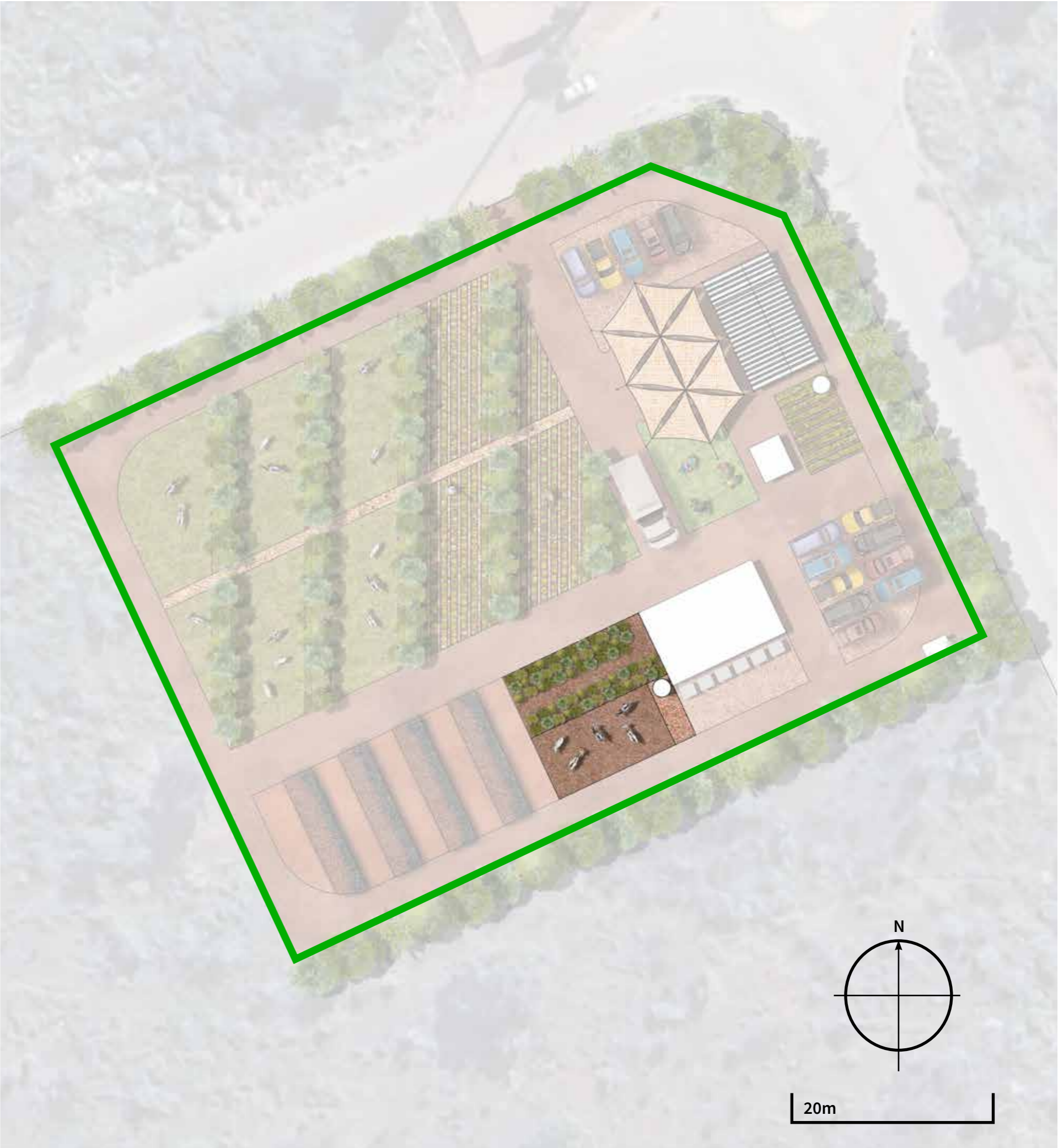

# CONCEPT-RECYCLING

## PRECEDENT IMAGERY

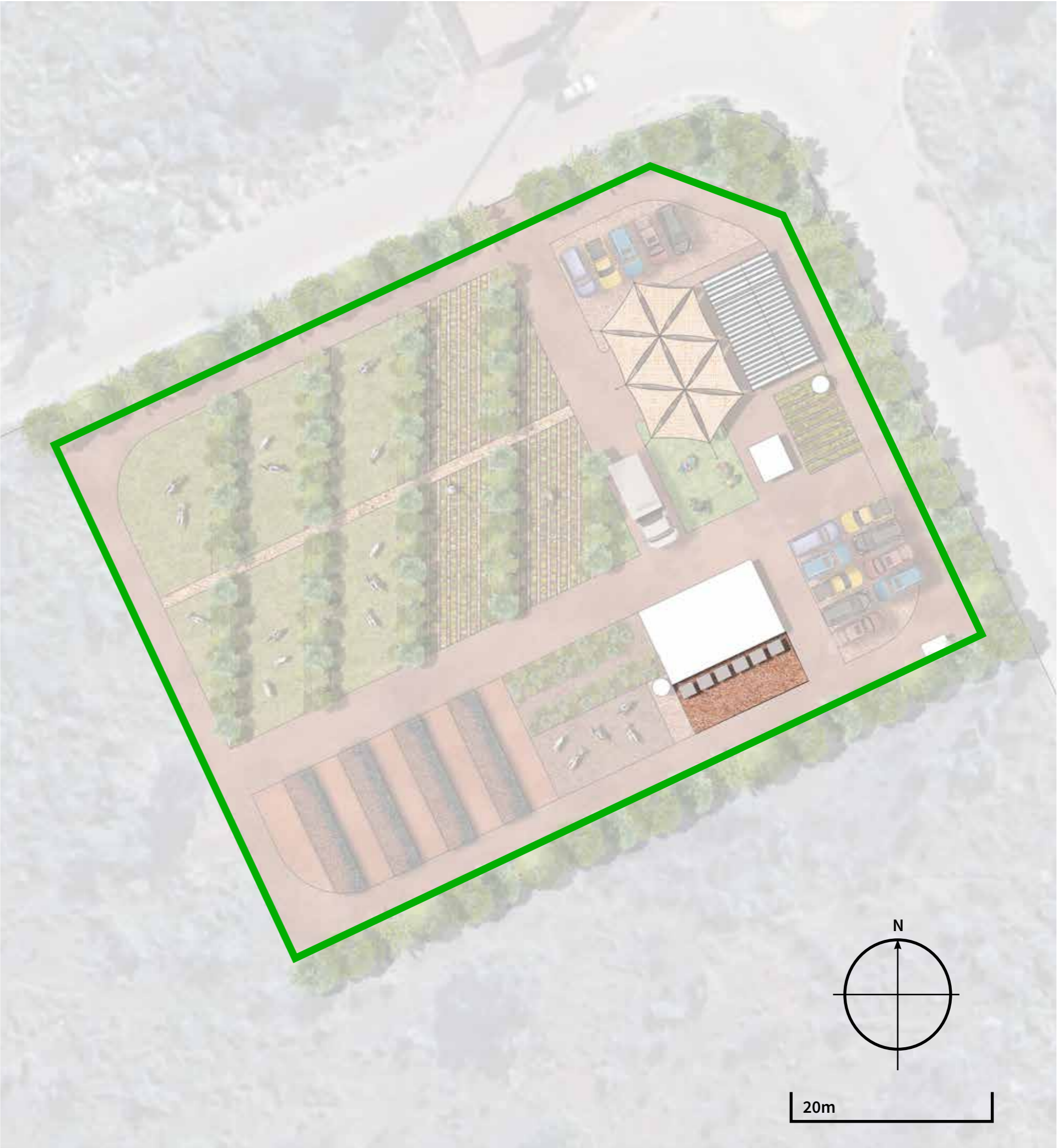

# CONCEPT-COMPOST

## PRECEDENT IMAGERY

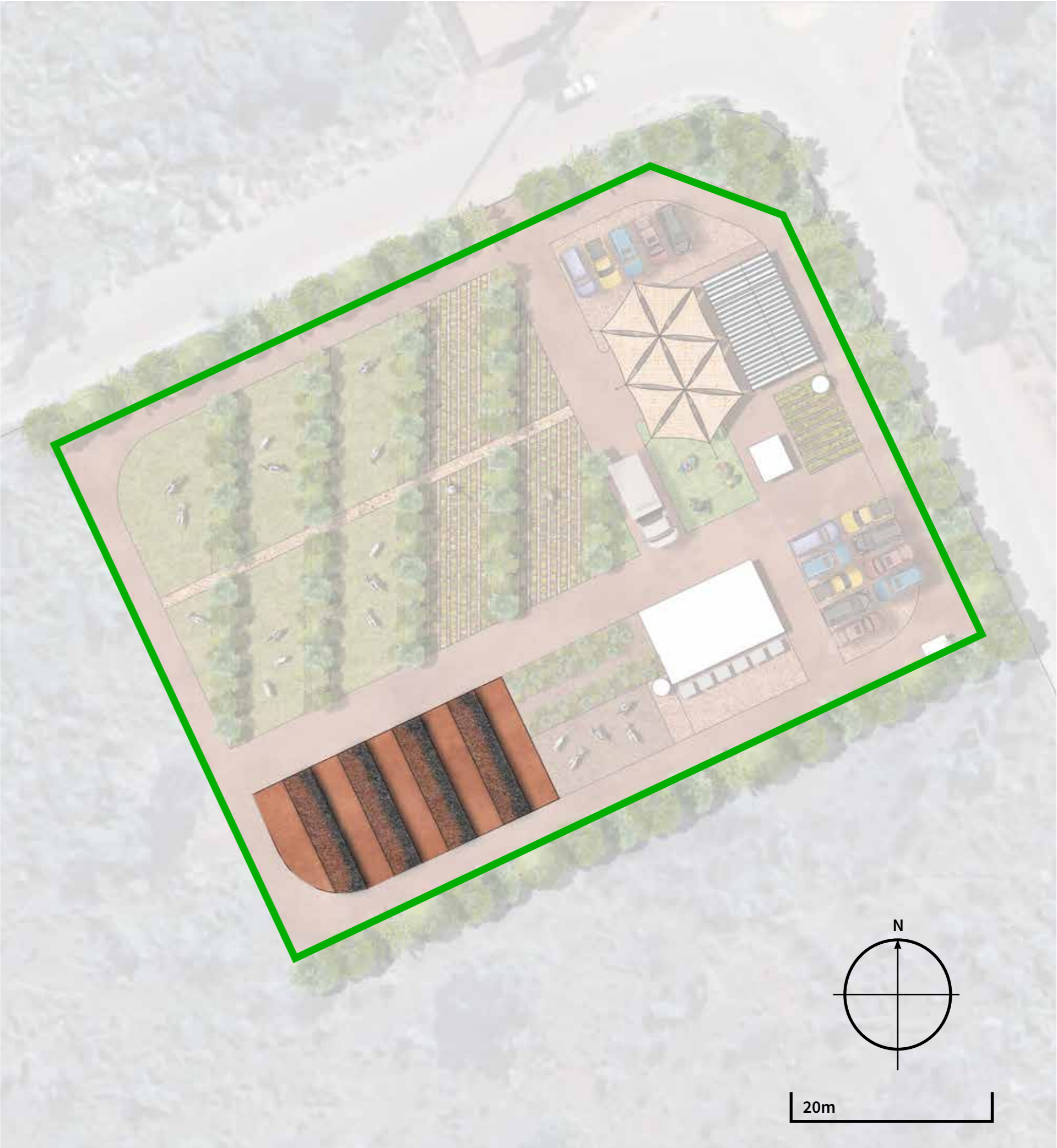

# CONCEPT-AGROFORESTRY

## PRECEDENT IMAGERY

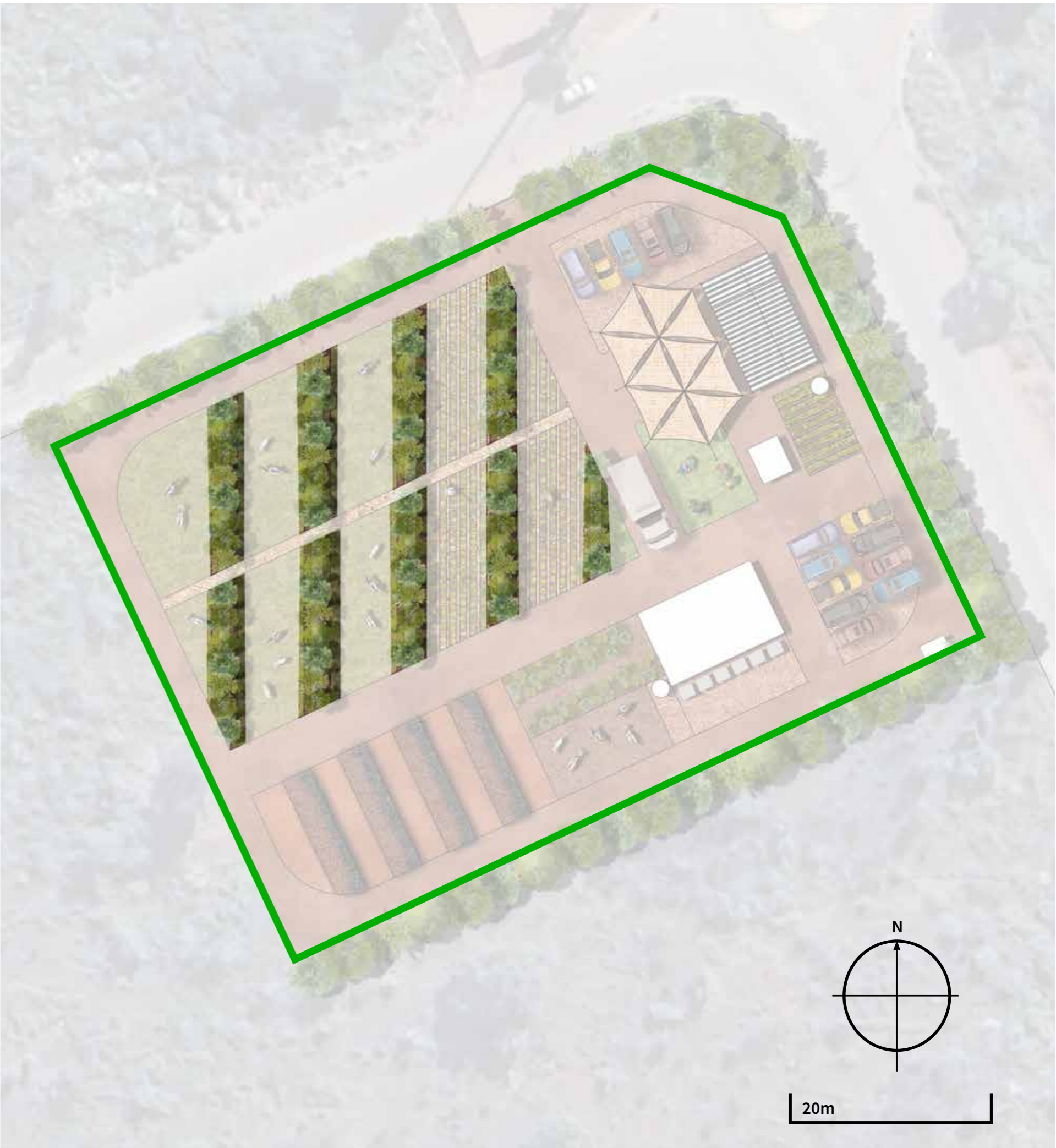

# CONCEPT-MARKET GARDEN, HERBS

## PRECEDENT IMAGERY

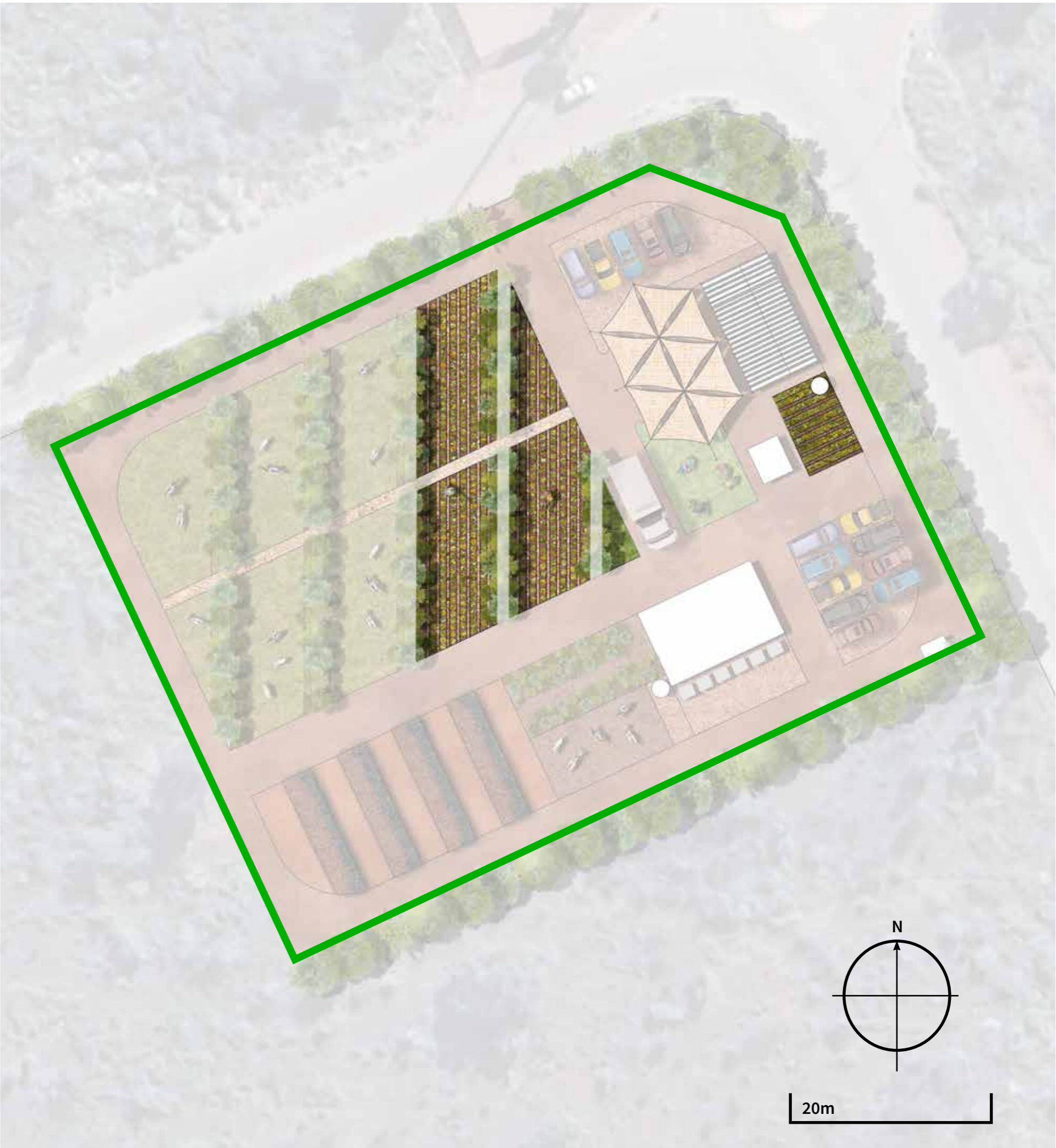

# CONCEPT-SILVOPASTURE

## PRECEDENT IMAGERY

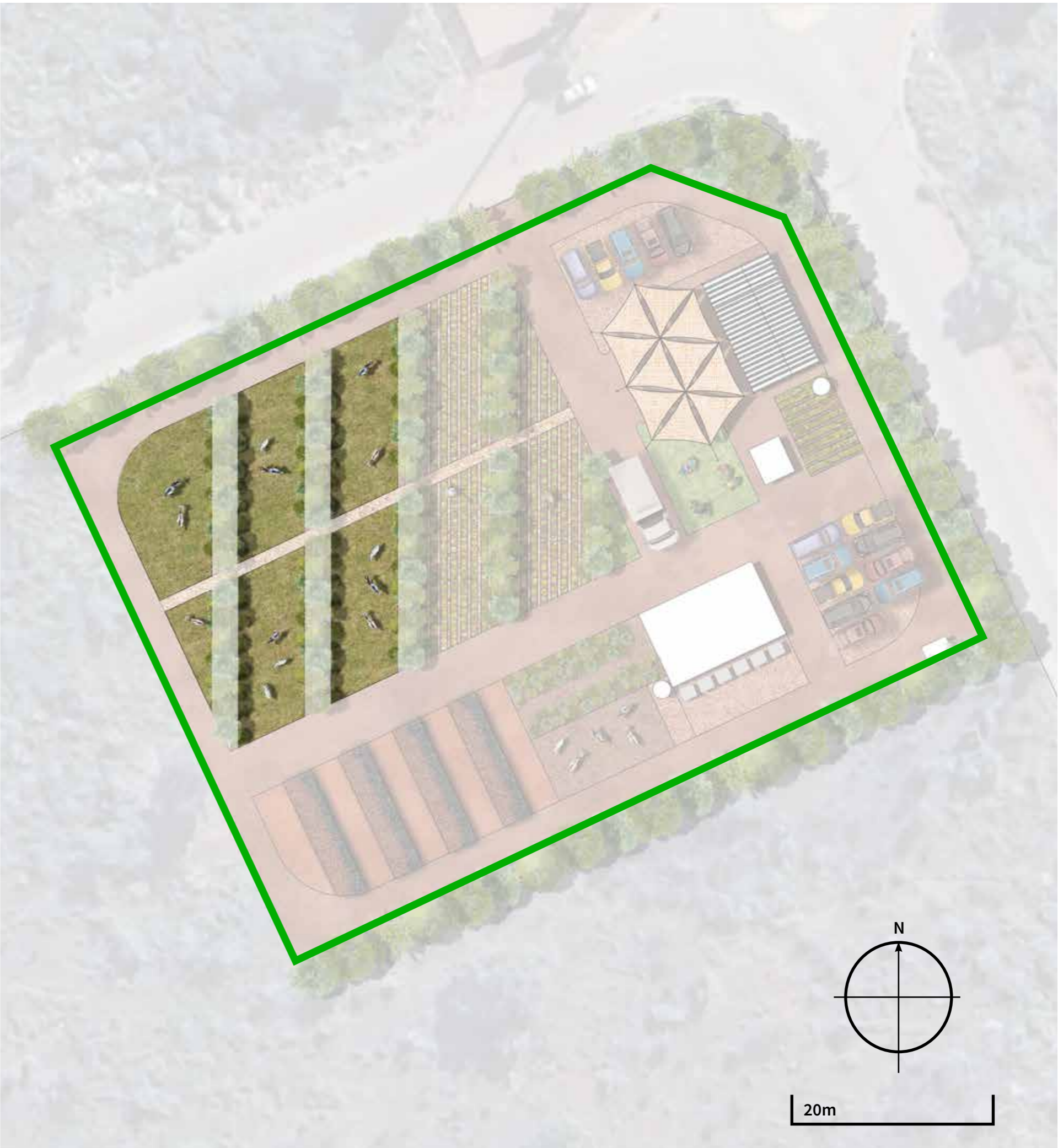

# CONCEPT-BOUNDARY TREATMENT

## PRECEDENT IMAGERY



THANK YOU !

